

Installation Instructions

NPL-Series Projector Mount

DISCLAIMER

This document is intended to be made accurate and complete. However, there is no guarantee the information contained herein covers every aspects. The manufacturer and the distributor make no representation of any warranty regarding the information contained, and assume no corresponding responsibility.

WARNING: If the ceiling structure could not support 5 times the weight of mount and the projector, please reinforce the ceiling prior to the installation. Installation on drywall may be dangerous.

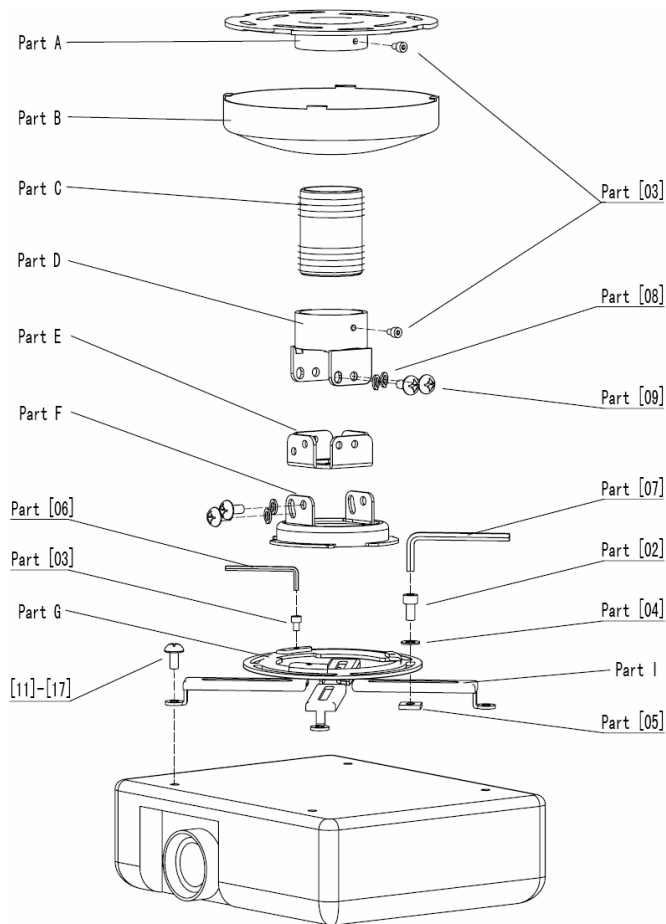

(Figure 1)

Legend

CABLE MANAGEMENT

Only follow when cables need to be hidden in the channels.

OPTIONAL

These parts and/or descriptions are optional and may not applicable to every installation.

Parts List

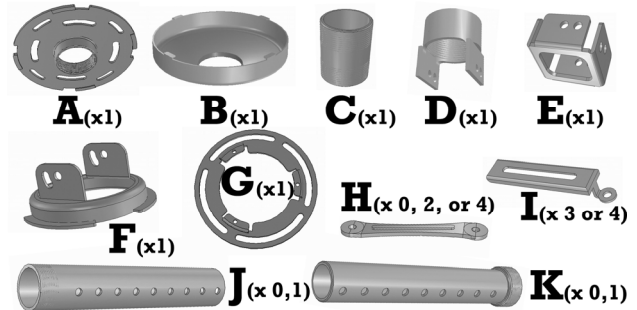

(Figure 2)

OPTIONAL Quantity 0 means optional parts. Your order detail determines what part you actually get.

Screw List

Wood Screw	PART [01]	Projector Screws	
Long Hex Screw (M6 x 12mm)	PART [02]	M6 (6mm) Philips Screw	PART [11]
M4 Hex Set Screw	PART [03]	M5 (5mm) Philips Screw	PART [12]
M6 Flat Washer	PART [04]	M4 (4mm) Long Philips	PART [13]
M6 Square Nut	PART [05]	M4 (4mm) Short Philips	PART [14]
M4 Allen Wrench	PART [06]		
M6 Allen Wrench	PART [07]	M3 (3mm) Long Philips	PART [15]
M6 Lock Washer	PART [08]	M3 (3mm) Short Philips	PART [16]
M6 Philips Screw (M6 x 8mm)	PART [09]	M2.5/2.6 (2.5mm) Philips	PART [17]

Note: Part [08] and Part [09] are already installed on the mount. So they are not in the hardware bag.

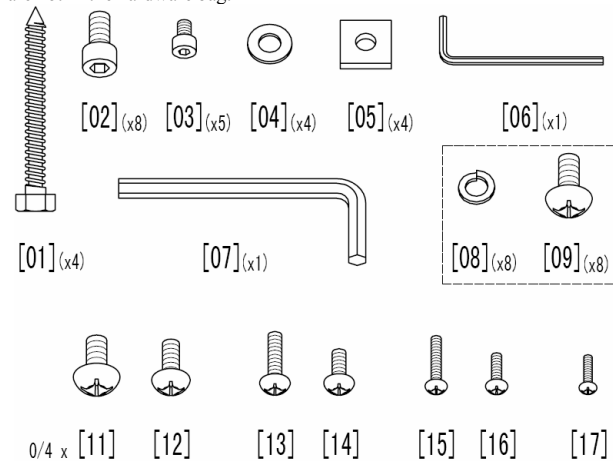

Projector screws

(Figure 3)

OPTIONAL Depending on your projector model, you may only get certain projector screws listed above.

Attach interface bracket to the projector

NPL-Series Projector Mount

Invert the projector, identify three or four tiny screw holes at the bottom. Attach the interface arms (Part-I) to the projector using screws Part [11]-[17].

For different projectors, the interface arms could be in different arrangements. See following figures for examples.

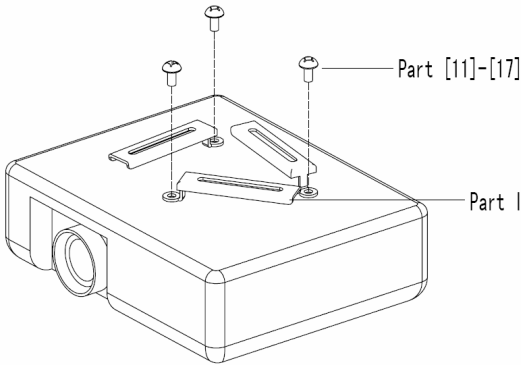

(Figure 4)

Above arrangement is typical for Optoma H27, H31, EP719, EP739, DELL 2100MP, 2300MP, HP projectors.

Then place (Part-G) on to the interface arms (Part-I), secure them using (Part-[02], Part-[04], Part-[05]), also see Figure-1 for details.

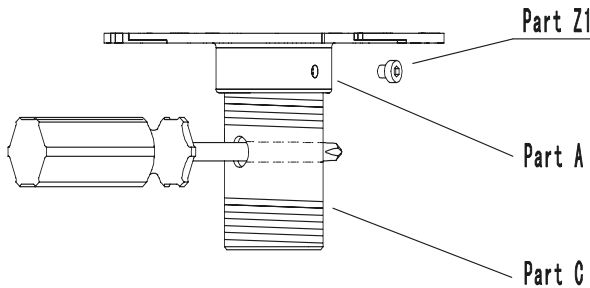

(Figure 5)

OPTIONAL Figure-6~8 show several examples for how to install on various projectors.

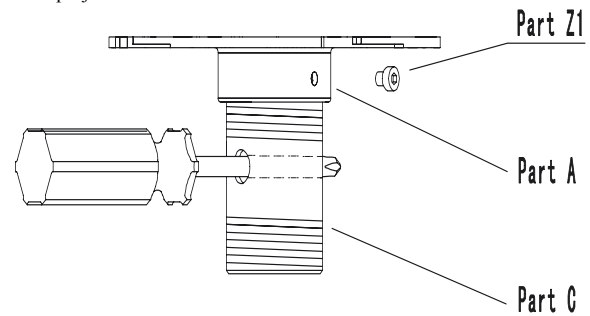

(Figure 6)

Above arrangement is typical for Optoma HD72 projector.

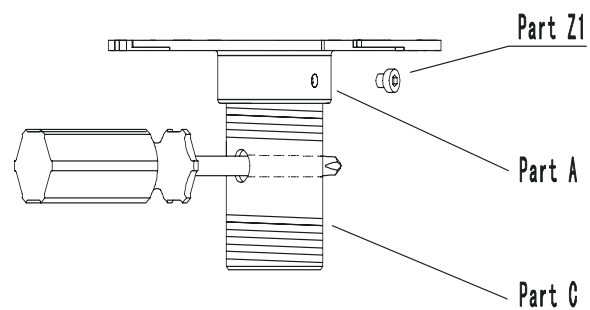

(Figure 7)

Above arrangement is typical for Sharp XR-10S, 10X, 20S, 20X, 11XC projectors.

Installation Instructions

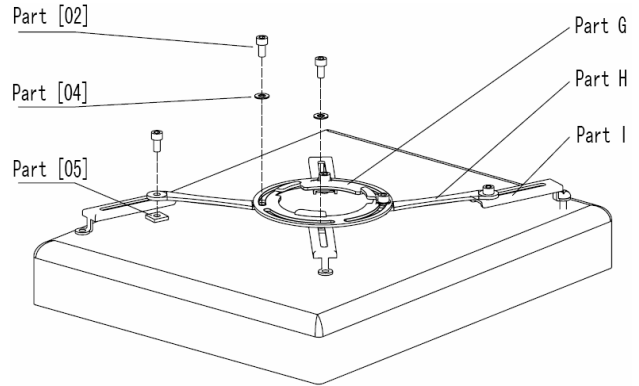

(Figure 8)

Above arrangement is for the projector with large screw span when the extension arms (Part-H) are used.

Install the ceiling plate

Wood stud: To install to a typical wood stud ceiling, first identify the wood stud using a stud finder, then secure the ceiling plate (Part-A) to the ceiling using wood screws (Part-[01]).

Warning: The supplied wood screws (Part-[01]) may be used with a drill, but it must be hand tightened using wrench to avoid damaged on the threads.

Concrete ceiling: Drill holes for the concrete anchor*, insert the anchors, then have the wood screws screwed into the anchors.

*concrete anchor is sold separately, or available in local hardware stores.

False/Drop/Suspended ceiling:

Using our suspended ceiling adaptor, the mount could be installed underneath drop ceiling tile. The suspended ceiling adaptor will be supported by the true ceiling structure.

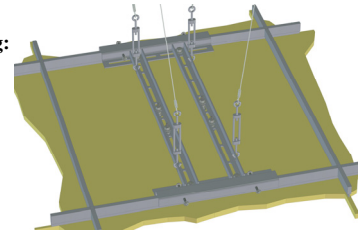

See Figure-10 for the measurement of Part-A, before you drill holes on the ceiling.

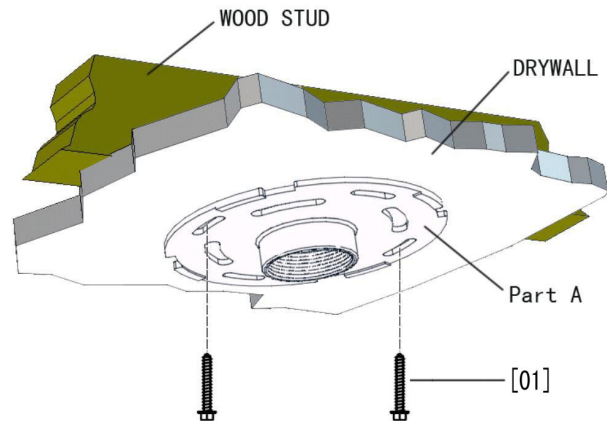

(Figure 9)

OPTIONAL

The threaded rods and U-Bolt shown on below on Figure-10 are only used with following applications. Not applicable to normal residential wood structures

Threaded Rod / Trusses / I-Beams / Unistrut: See Figure-10, use inner four holes to install with four 1/4" or 5/16" threaded

rods.

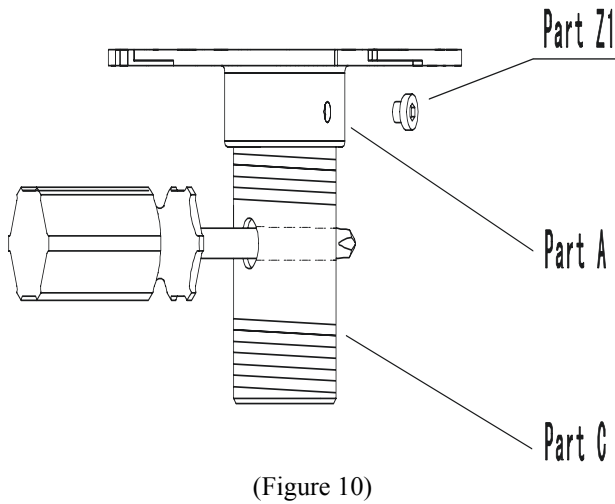

(Figure 10)

CABLE MANAGEMENT Insert the cables through the central hole on the Ceiling Plate (Part-A) before you tighten the screws (Part-[01]).

Assemble the NPL projector mount

a) Attach Part-C

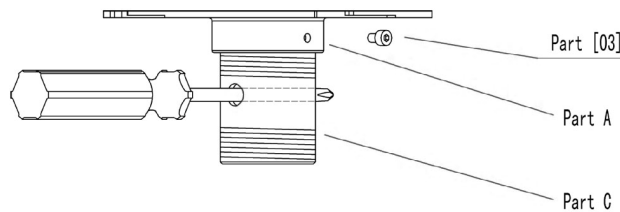

(Figure 11)

Install Part-C to Part-A, a screw driver may be used to help tighten the connection.

Warning: Take your own risk to use the screw drive for this purpose. We are not responsible for damaged caused if the screw driver is broken.

Use a M4 set screw (Part-[03]) to lock the position between Part-C and Part-A. Tighten Part-[03]

b) Attach Part-B and Part-D

Part-B could be snapped to the ceiling plate (Part-A), then turn Part-B clockwise, it will be locked on the ceiling.

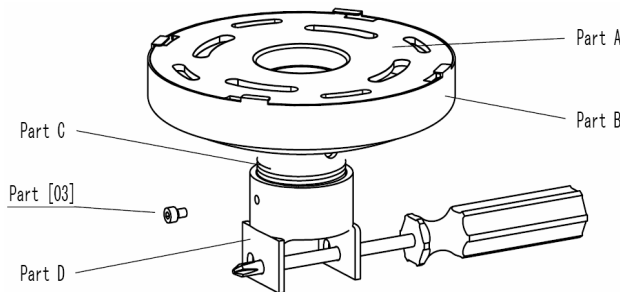

(Figure 12)

A set screw Part-[03] is used lock Part-C and Part-D, however, do NOT tighten it until YAW adjustment is completed.

Warning: Take your own risk to use the screw drive for this purpose. We are not responsible for damaged caused if the screw driver is broken.

Note: The connection between Part-C and Part-D could be waited to tightened after Part-D,E is connected together. Also see Figure-15.

c) Connect Part-D,E,F

Part D, E, F have secured using 8 Philips screws (Part-[09], M6x8mm).

CABLE MANAGEMENT Cables go through Part-D,E, but not Part-F. See Figure-13, cables in and out above Part-F, but turn underneath Part-F. This is to avoid unnecessary force to affect the position between Part-E and Part-F.

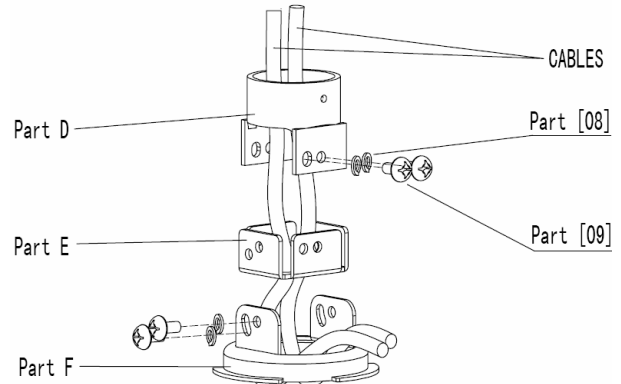

(Figure 13)

Attach/detach the projector; Quick release feature

Projector with interface bracket installed could be easily connected to the mount. Snap Part-F into Part-G and turn the projector clockwise. Then tighten the lock screws (Part-[03]) to lock Part-G.

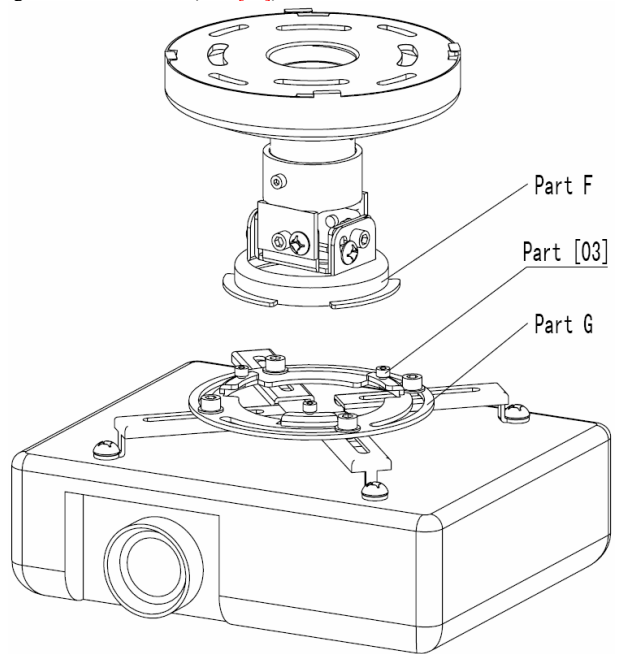

(Figure 14)

Three-Way Adjustments

a) YAW (Horizontal rotate) adjustment

Yaw adjustment is performed between Part-C and Part-D. Tighten screw Part-[03] to lock the position

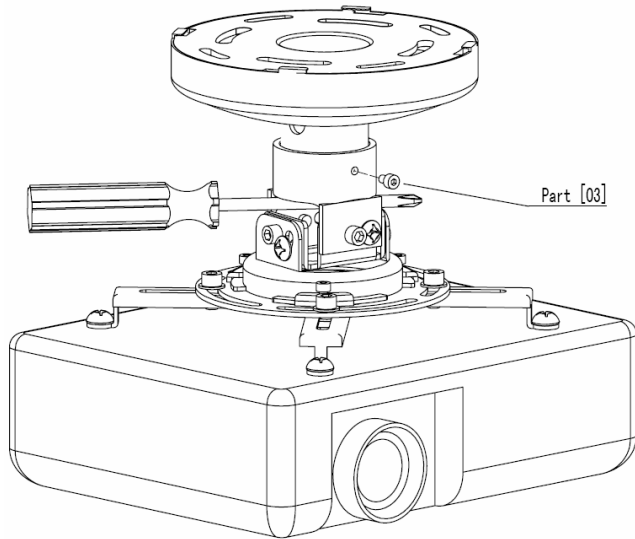

(figure 15)

Warning: Take your own risk to use the screw drive for this purpose. We are not responsible for damaged caused if the screw driver is broken.

b) PITCH (Tilt up and down) adjustment

Adjust the two Philips screws (Part-[09]) on Part-F to adjust the angle of pitch. See Figure-16.

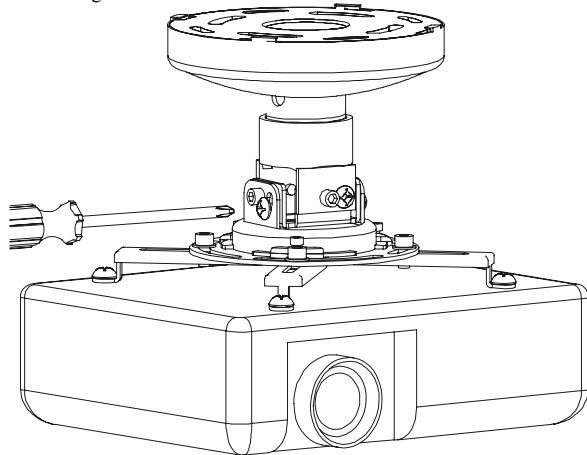

(figure 16)

c) ROLL (Tilt side to side) adjustment

Adjust the two Philips screws (Part-[09]) on Part-D to adjust the angle of roll. See Figure-17.

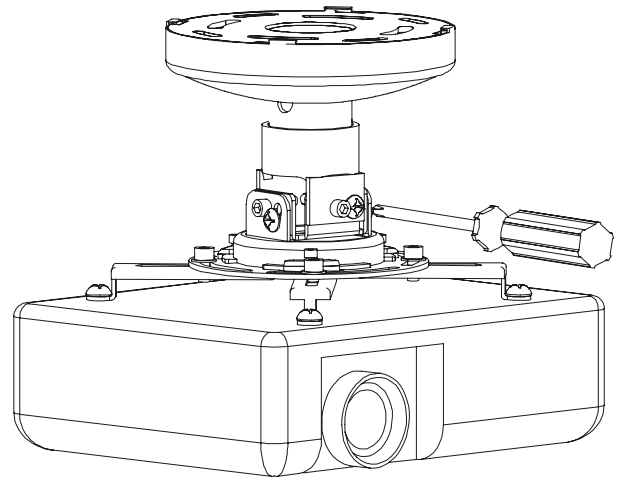

(figure 17)

Install with optional extension pipes

OPTIONAL We offer a variety of extension pipes from fixed length extensions to adjustable (telescopic) extensions. Standard 1.5" NPT may be used with the NPL mount to achieve desired length as well.

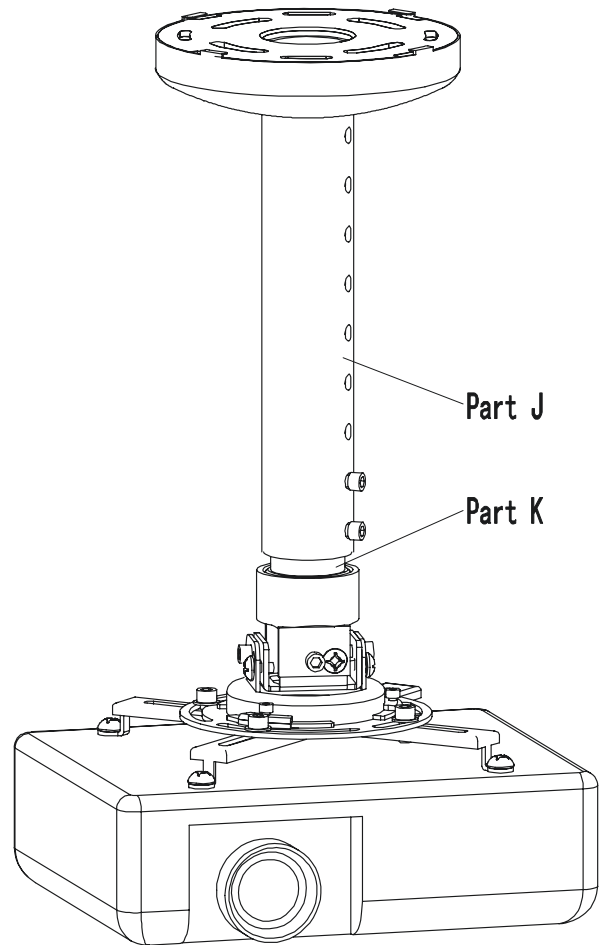

(Figure 18)

Shown in Figure-18 is the installation with our adjustable extension.